

08/10/17 G:\0\Projects\T-16628 SH 74 @ NW 178th, NW 192nd & NW 206th\CAD\TC PHASE 2M_6 SH 74.dgn

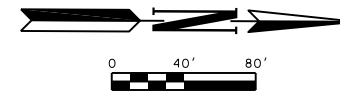

REVISIONS		
NO.	DESCRIPTION	DATE

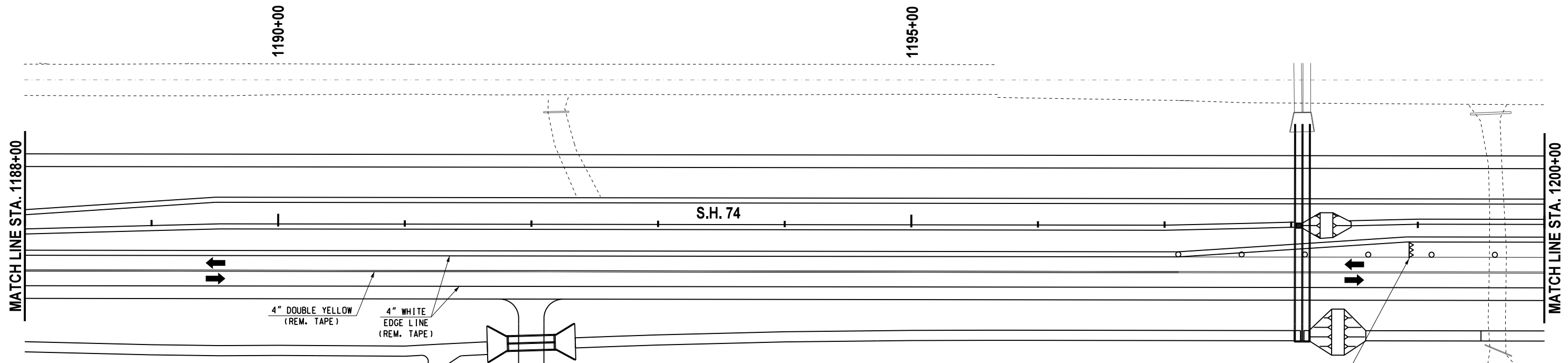

ALL PAVEMENT MARKINGS SHALL BE REMOVABLE TAPE

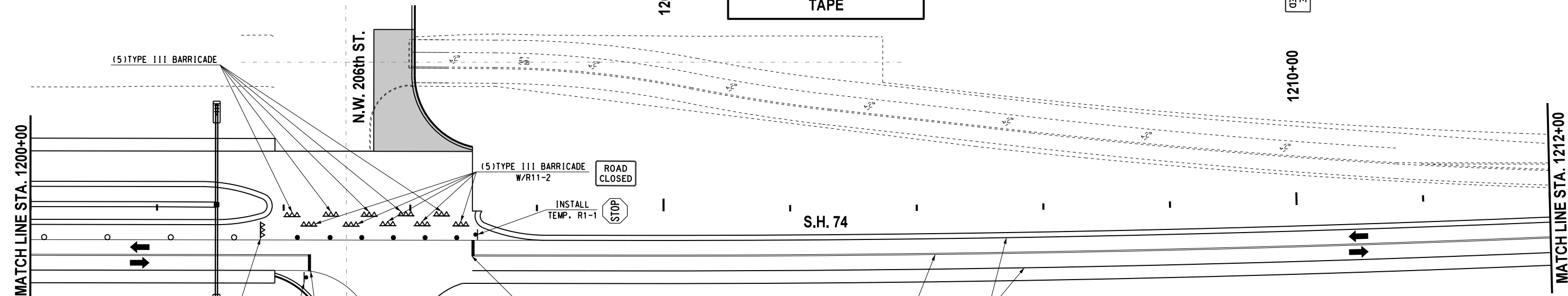

CONTRACTOR SHALL KEEP 11' MINIMUM LANES UNLESS OTHERWISE NOTED.

CONTRACTOR TO PROVIDE ACCESS TO ALL DRIVEWAYS DURING CONSTRUCTION.

LEGEND	
△△△	- TYPE III BARRICADE W/ TWO TYPE "A" LIGHTS
●	- DRUM
○	- CHANNELIZER CONE
▬	- PORTABLE CONC. BARRIER WALL
▬▬▬	- CONSTRUCTION ZONE IMPACT ATTENUATOR
■	- WORK AREA

Design	RWR	08/10/17
Drawn	GDB	08/10/17



TRAFFIC CONTROL
PHASES 2M (SHEET 6 OF 7)
S.H. 74 (STA. 1188+00 TO 1212+00)
 State Job No. 14964(08) Sheet No. 157